

EAST EDISTO

RURAL DISTRICT

SAVANNAH HWY TRACT - PRICE REDUCED

Charleston County, SC | 16.161 acres | \$9,500 per acre

Description

Just minutes from the heart of Charleston, the Savannah Hwy Tract represents a rare opportunity to own land in one of the world's most celebrated cities. Accessibility via 3,700+ feet of Savannah Hwy frontage and topography of the land make it an ideal homesite with room for exploring the Lowcountry landscape. Substantial, mature timber is ready to harvest now, allowing an immediate return on your investment.

Because the rural character of East Edisto will be protected in perpetuity, this property offers another important benefit: enduring legacy. Being at the heart of family life, generation after generation.

Charleston County properties are hard to find. Call today to schedule your tour of the Savannah Hwy Tract.

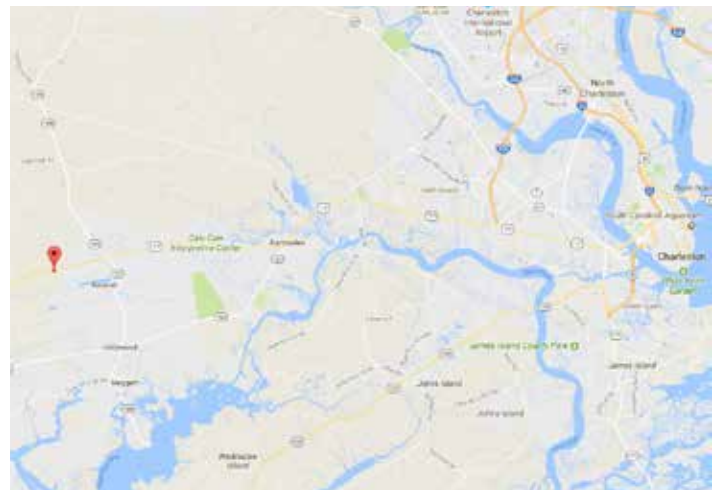

[See in Google Maps](#)



WestRockLandSales.com | 843-509-1034

SAVANNAH HWY TRACT - PRICE REDUCED

Charleston County, SC | 16.161 acres | \$9,500 per acre



Source: Esri,
DigitalGlobe,



0 0.05 0.1 0.2 Miles

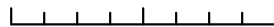

1:7,920

Savannah Hwy Tract
16.161 Acres
Charleston County, SC

SAVANNAH HWY TRACT - PRICE REDUCED

Charleston County, SC | 16.161 acres | \$9,500 per acre

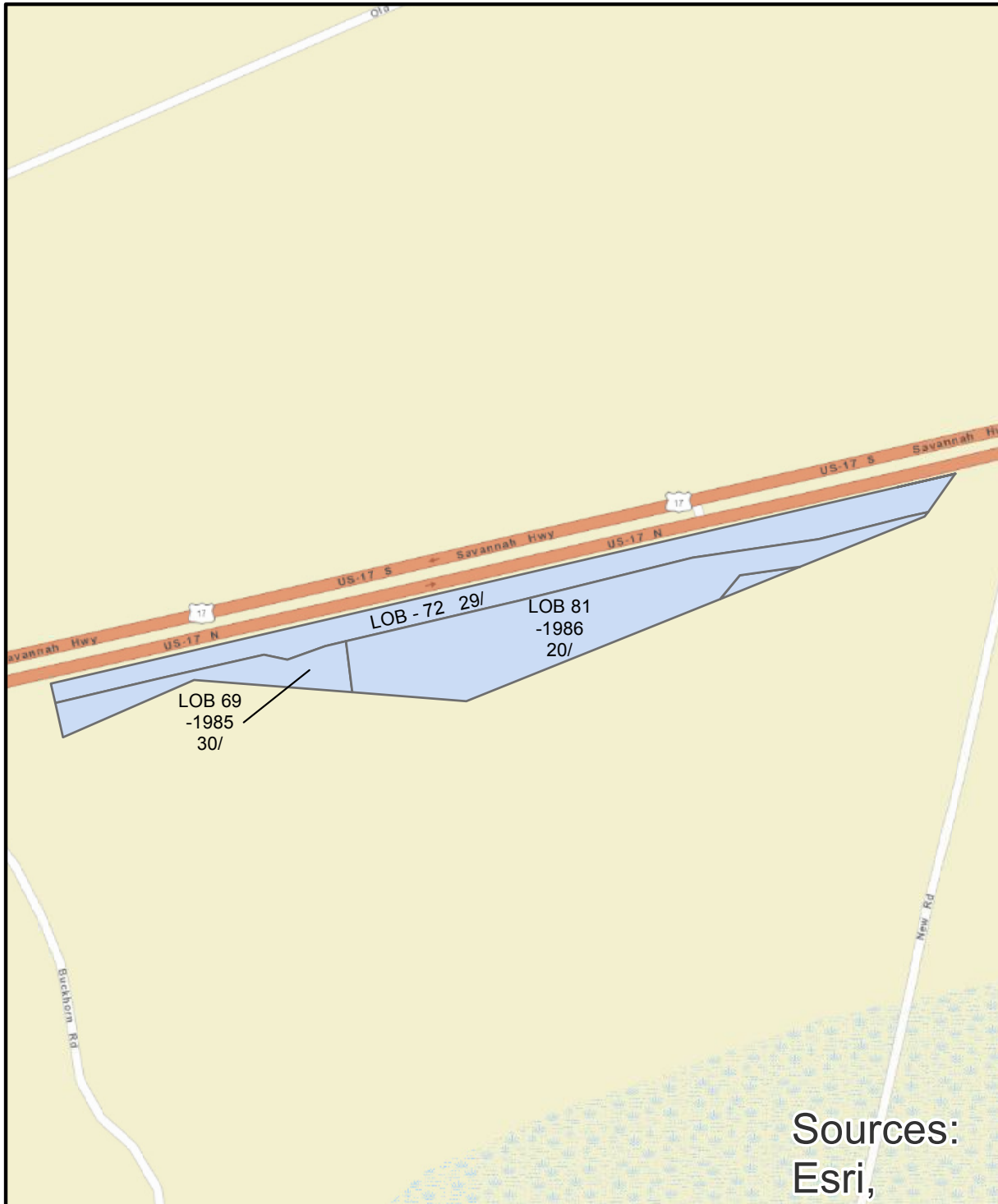

0 0.0250.05 0.1 Miles
1:5,575

Savannah Hwy Tract
16.161 Acres
Charleston County, SC

SAVANNAH HWY TRACT - PRICE REDUCED

Charleston County, SC | 16.161 acres | \$9,500 per acre



SAVANNAH HWY TRACT - PRICE REDUCED

Charleston County, SC | 16.161 acres | \$9,500 per acre

